

PLAN

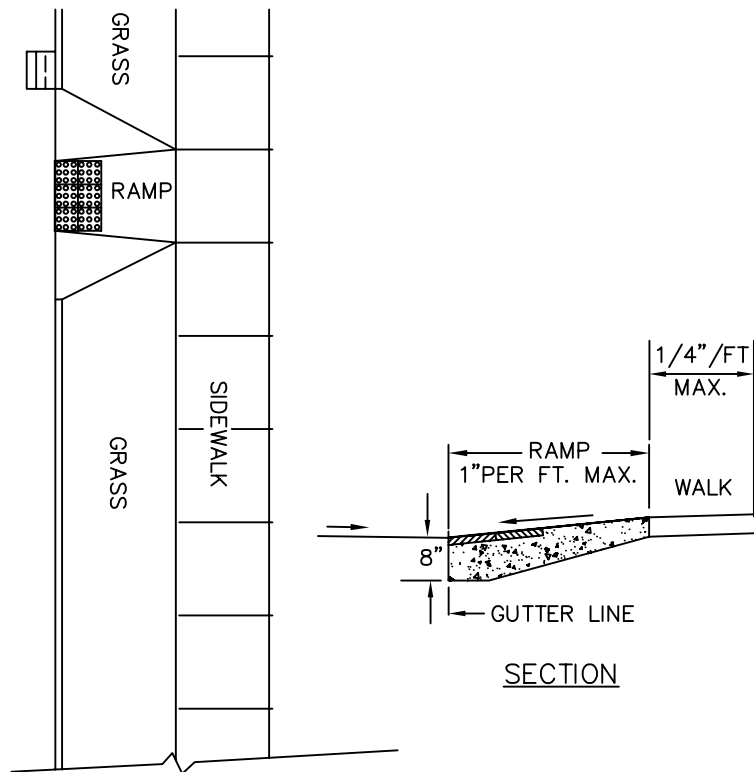

SECTION

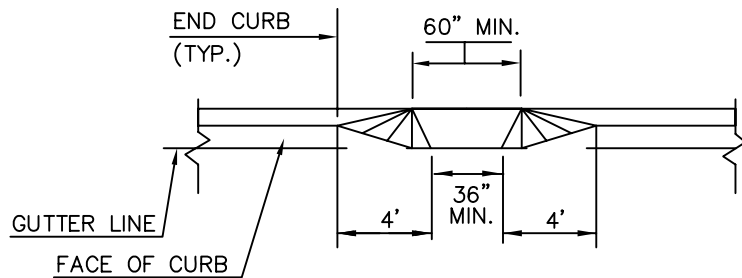

FRONT
SIDEWALK RAMP

NOTES:

1. ALL SIDEWALK RAMPS SHALL BE CONSTRUCTED IN ACCORDANCE WITH THE DETAILS FOR 8" CONCRETE SIDEWALK (DRIVEWAY), EXCEPT THAT THE FINAL TEXTURE OF THE CONCRETE SURFACE SHALL BE A COARSE BROOM FINISH TRANSVERSE TO THE SLOPE OF THE RAMP.
2. CARE SHALL BE TAKEN TO ASSURE A UNIFORM GRADE ON THE RAMP AND SLOPE OF SIDES TO RAMP, FREE OF SAGS AND SHORT GRADE CHANGES.
3. ALL SIDEWALK RAMPS SHALL BE CONSTRUCTED OF PORTLAND CEMENT CONCRETE.
4. DRAINAGE DESIGN IN THE VICINITY OF SIDEWALK RAMPS SHALL BE CONSIDERED AN INTEGRAL PART OF THE DESIGN OF THESE RAMPS. NO DRAINAGE STRUCTURES SHALL BE WITHIN THE LIMITS OF THE SIDEWALKS AND CROSSWALKS.
5. WIDTH OF SIDEWALK RAMP SHALL BE MIN. 36".
6. SIDEWALK RAMPS SHALL CONFORM TO ADA REQUIREMENTS.



TOWN OF WINDSOR
Engineering Department



CONCRETE SIDEWALK RAMPS
D-206



SCALE: HOR. NTS DATE: MARCH 2009
VER.